

N. 15^o W. 1/4
50 perch
untaken up

A MAP of JOHN SPENCER'S LAND SURVEYED and RETURNED to the GOVERNOR'S SECRETARIES OFFICE as being in my office & returned to the GOVERNOR'S SECRETARIES OFFICE in the 11th of 12^{mo} 83
W. 15^o S. 1/4
Land not settled
by Capt Markham

A Warrant for this Land was granted by the DEPT^y GOVERNOR & the 11th of 7^{mo} 82
This lies in y^e County of Bucks
Laid down by a scale of 40 perch in an Inch

pages 100 107
K.T. No. 51. E
-used the 10th of 6^{mo} 83 containing 125^a & bounded as in this figure.

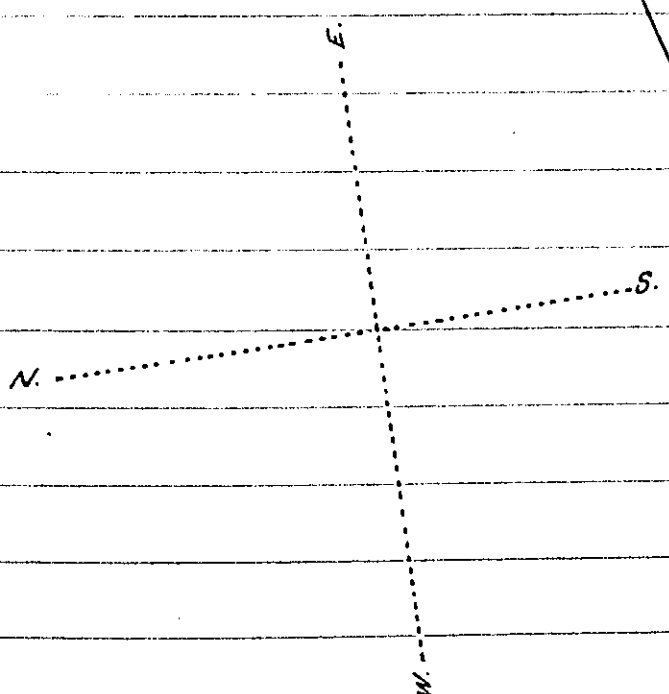

IN TESTIMONY that the above is a copy of the original remaining on file in the Department of Internal Affairs of Pennsylvania, made conformably to an Act of Assembly approved the 16th day of February, 1833, I have hereunto set my Hand and caused the Seal of said Department to be affixed at Harrisburg, this Twentieth day of April 1909

Henry Howell

Secretary of Internal Affairs.